

Turning Inserts(Negative)

CN□□

Rhombic 80° with Hole

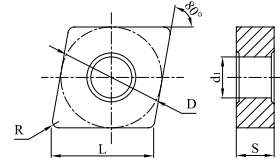

Ordering Code	Dimension(mm)					Coated												Uncoated	Cermet								
	L	D	S	d ₁	R	GP1105	GP1115	GP1120	GP1225	GP1135	GP3125	GM1115	GM1125	GM3215	GM3225	GS3115	GS3125	GK1115	GK1120	GK1125	GK1130	GN9115	GN9120	GN9130	GP91TF	GP91TM	
	CNMG120404-UK	12.9	12.7	4.76	5.16	0.4												●	●	●							
	CNMG120408-UK	12.9	12.7	4.76	5.16	0.8												●	●	●	●						
	CNMG120412-UK	12.9	12.7	4.76	5.16	1.2												●	●	●	○						
	CNMG120416-UK	12.9	12.7	4.76	5.16	1.6												●	○	●	○						
	CNMG160608-UK	16.1	15.875	6.35	6.35	0.8												●	●	●	○						
	CNMG160612-UK	16.1	15.875	6.35	6.35	1.2												●	●	●	○						
	CNMG160616-UK	16.1	15.875	6.35	6.35	1.6												●	○	●	○						
	CNMG190612-UK	19.3	19.05	6.35	7.94	1.2												●	○	●	○						
	CNMG190616-UK	19.3	19.05	6.35	7.94	1.6												●	○	●	○						
	CNMG120408-QR	12.9	12.7	4.76	5.16	0.8	●	●	●	●																	
	CNMG120412-QR	12.9	12.7	4.76	5.16	1.2	●	●	●	●																	
	CNMG120416-QR	12.9	12.7	4.76	5.16	1.6			●																		
	CNMG160608-QR	16.1	15.875	6.35	6.35	0.8			●																		
	CNMG160612-QR	16.1	15.875	6.35	6.35	1.2	●	●	●	●																	
	CNMG160616-QR	16.1	15.875	6.35	6.35	1.6	●		●	●																	
	CNMG190608-QR	19.3	19.3	6.35	7.94	0.8			●	●																	
	CNMG190612-QR	19.3	19.3	6.35	7.94	1.2			●	●																	
	CNMG190616-QR	19.3	19.3	6.35	7.94	1.6			●	●																	
	CNMG190624-QR	19.3	19.3	6.35	7.94	2.4		○		●	○																
CNMG250924-QR	25.8	25.4	9.52	9.21	2.4			●																			
	CNMG120408-HK	12.9	12.7	4.76	5.16	0.8												●	●	●	○						
	CNMG120412-HK	12.9	12.7	4.76	5.16	1.2												●	●	●	○						
	CNMG120416-HK	12.9	12.7	4.76	5.16	1.6												●	●	●	○						
	CNMG160612-HK	16.1	15.875	6.35	6.35	1.2												●	●	●	○						
	CNMG160616-HK	16.1	15.875	6.35	6.35	1.6												●	●	●	●						
	CNMG190612-HK	19.3	19.05	6.35	7.94	1.2												●	●	●	○						
CNMG190616-HK	19.3	19.05	6.35	7.94	1.6												●	○	●	○							

● Stock ○ Available Upon Order